

**THE PARISH CHURCH  
of  
ST. MARY THE VIRGIN  
DEANE, BOLTON**



**CELEBRATION WEEK-END  
September 26th, 27th, 28th, 1986**

## **WHO'S WHO**

### **RECTOR**

ROGER B. JACKSON

The Rectory, 234 Wigan Road. Tel.: 61819

### **VICAR**

ROBIN HAZLEHURST

St. Andrew's Vicarage, Crescent Avenue. Tel.: 651851

### **CURATE**

JOHN CORBYN

281 Deane Church Lane. Tel.: 64313

### **WARDENS**

MAJOR CROOK - HARRY RIDYARD - TOM STOKES

## **CELEBRATION EVENTS**

### **FRIDAY, 26th September**

Noon - 6.30 p.m. Church open for viewing of Floral Displays

7.00 p.m. Organ Recital by Norman Cunliffe

7.30 p.m. Deane Church Through the Ages  
(Mrs. Marie Mitchell - Local Historian)

followed by Cheese and Wine

### **SATURDAY, 27th September**

9.30 a.m. - 6.00 p.m. Church open for viewing of Floral Displays

7.15 p.m. Concert by New Rosemere Amateur Operatic Society

### **SUNDAY, 28th September**

Noon - 6.00 p.m. Church open for viewing of Floral Displays

8.00 a.m. Holy Communion

10.30 a.m. Family/Parade Service

Preacher: The Rector

6.30 Family Communion

Celebrant: The Bishop of Bolton

Preacher: David M Hallatt, Rector of Didsbury

**THERE WILL BE SPECIAL RINGING OF THE BELLS DURING THE WEEK-END**

Photograph on front cover by courtesy of Manor, Kay & Foley



to our ancient Parish Church of St. Mary  
Thank you for joining us at this Week-end of

We celebrate with thanksgiving not only centuries of Christian history but also the completion of three years of extensive restoration and redecoration work. This combined with the floral displays and music should make our building as attractive a place to visit as it ever has been. We hope you find it so.

ROGER B. JACKSON

Our Church is made for PRAYER and you are welcome to pray in God's House amongst all His beauty. The following prayers are suggested:

# THANKSGIVING

Thanks be to thee, our Lord  
Jesus Christ,  
For all the benefits thou hast  
won for us,  
For all the pains and insults thou  
hast borne for us.  
O most merciful Redeemer,  
Friend, and Brother,  
May we know thee more clearly,  
Love thee more dearly,  
And follow thee more nearly,  
Day by day.

---

# MARKLANDS PIES

Try Our Delicious  
PIES and FANCY CAKES

292 WIGAN ROAD, DEANE, BOLTON

---

## BEAUMONT HOSPITAL

*wishes the Parishioners of  
St. Mary The Virgin, Deane much success  
with their Weekend of Celebration*

Bolton Independent Hospital PLC  
Old Hall Clough, Chorley New Road  
Lostock, Bolton BL6 4LA  
Telephone: Bolton 494211

---

## Scott Brake & Auto Parts Ltd.

9 BURY NEW ROAD, BOLTON  
Tel.: 28512/28969/31666

Bolton's Main Stockists and  
Distributors of British and  
Foreign Automotive Motor Parts

**'WHERE QUALITY COSTS LESS'**

---

## FLETCHER LIVING DESIGNS

*Builders of Quality Homes in the Bolton area  
offer their Best Wishes to Deane Parish Church  
on this happy occasion*

229a ASHLEY ROAD, HALE  
CHESHIRE  
Telephone: 061-928 6148

---



# Crest Hotel

## Bolton

Bring the Family to a 3-Course Sunday  
Lunch - £6.25 fully inclusive  
Children only £3.00

IN ORDER TO AVOID  
DISAPPOINTMENT

**BOOK NOW ON BOLTON 651511**

---

## Taylorvision

SPECIALISTS IN COLOUR T.V. & VIDEO (Sales & Rental)

Stockists of UNIT AUDIO EQUIPMENT

**1 HULTON LANE, BOLTON BL3 4JB**

Proprietor: D.J.J. TAYLOR

**Telephone: Bolton 64375**

---

## Aspinall & Co

Solicitors

15 Wood Street, BOLTON 388200  
79 Lee Lane, HORWICH 693219  
Working for YOU !

\*Residential/Industrial Conveyancing \*Family problems \*Wills and Probate \*Accident Claims \*Leases  
\*Motor/Criminal Offences \*Written estimates on request AND OTHER PERSONAL LEGAL PROBLEMS





# A BRIEF HISTORY

---

Tradition claims that a Saxon Church existed on the site of the present Church.

Dene (the original spelling which means 'valley') is mentioned in the Domesday Book and there is documentary evidence of a Church on this site in later Norman times as the Chapel of Saynte Mariden.

The present Deane Church is recorded as having been erected in 1452 although it appears to have developed gradually from a small 14th Century Chapel.

Continuous additions and alterations have taken place in the intervening 500 years to the present day. Most notably the 16th Century saw many changes including the rebuilding of the Nave and Clerestory and a new oak panelled roof and extensions to the aisles.

In 1522 the original name of Saynte Mariden was dropped in favour of Deane Church.

Henry VIIIth assumed the title of 'Supreme Head on Earth of the Church of England' in 1535 and in 1541 he ordained, by letters patent, that Deane become the Parish Church of ten townships assigned to it.

George Marsh was born in Deane in 1515, was a Curate in London and because of his preaching in Deane, Eccles and elsewhere was martyred near Chester in 1555.

It was not until the 18th Century that further significant changes took place when galleries were added to the West and part South Walls.

The Vestry was added in 1822 and galleries were erected along the whole of the North and South Aisles in 1833 increasing the accommodation to 1229 seats.

The next major changes took place in 1884 when the galleries were removed, the Chancel extended by 10 feet, a new Oak roof provided which is an exact copy of the original, the organ relocated and extensive re-ordering of the interior.

Significant work has taken place during the 20th Century including alterations within the tower, re-casting of the Church Bells, a complete re-build of the organ, creation of the new chapel and finally the current restoration work and internal re-ordering.

Should these few words have whetted your appetite, why not purchase a copy of the newly published Deane Church book which gives more details and a pictorial guide to our beautiful and ancient Church.

DON OTTER

# A GUIDE TO THE FLORAL DISPLAYS

## LYCH GATE

The present Lych Gate was erected in 1903 to the memory of Thomas Withnell, Vicar from 1767 to 1776 by Ellen Lowe Ashton, a descendant. This area has been **decorated and sponsored by Barlows Garden centre.**

## GEORGE MARSH CROSS

This memorial was erected by the Vicar, the Rev. H.S. Patterson in 1893. The stone on which it stands is reputed to have been the base of an ancient Saxon Cross and was moved from New York, Junction Road to the Churchyard by Parishioners.

On entering the Church the decoration along the back has been **sponsored by Shaw & Son, Funeral Directors.**

## DOOMSDAY BOOK (1)

King William, after he had defeated the English at the Battle of Hastings, ordered his great survey of the country to be undertaken between 1080 and 1086, so this year is the 900th anniversary of its compilation. All the Lancashire Estates were recorded to be in the possession of the Crown. Dene is mentioned in the Domesday Book and so this is an ecclesiastical site of great antiquity. This display is **sponsored by the Post Office.**

## HENRY VIIIth AND THE DISSOLUTION OF THE MONASTERIES (2)

In 1535 King Henry dissolved the Monasteries. Abbott Paslew of Whalley Abbey tried to oppose this but was unsuccessful and was hanged in 1537. The Abbey was then seized by the King along with its possessions which included the Chapel of SAYNTE MARIDEN - the former name of St. Mary's Deane. This display has been **sponsored by Warburtons Bakery Ltd., and Bentley & Co., Chartered Accountants.**

In 1541 King Henry VIIIth by Letters patent ordained that the Chapel of Saynte Mariden be the PARISH CHURCH of the PAROCHIAL DISTRICT of ten townships assigned to it under ECCLES, for time immemorial, the Parish receiving the name DEANE after the ancient village. This document, complete with seal, is displayed nearby.

## TODAY'S CHURCH (3)

This display incorporates some of our present organisations: Cubs, Brownies, Scouts and Guides, Christian Youth Groups, Mothers Union and our Missionary Links through the South American Missionary Society, Bible Churchmen's Missionary Society and Tear Fund. These arrangements have been **sponsored by the Organisations themselves.**



## **JOHN WESLEY (4)**

John Wesley travelled the country far and wide preaching and declaring 'The World is my Parish'. He came to Bolton in 1748 and preached at the Market Cross. Methodism was born in song. Charles Wesley wrote the first hymns of the Evangelical Revival in 1738. The home of Samuel and Susannah Wesley, and the birth-place of John and Charles was the Rectory at Epworth, which was destroyed by fire in 1709, and from which John was rescued. This display has been sponsored by **Manor, Kay & Foley, Photographers.**

## **GEORGE MARSH - MARTYR (5)**

George Marsh was born c1515, the second son of George Marsh, farmer and woodstapler of Deane. He was educated at a local grammar school, then took up farming, married and raised several children.

After the death of his wife he went to study at Cambridge and in due course was ordained to the priesthood. He followed the reformed doctrine and because of this was arrested c1554. Condemned for heresy he was burnt near Chester on April 24th, 1555 . . . "His sufferings augmented by a barrel of pitch placed over his head".

This display is sponsored by **Graham Ball & Partners, Chartered Surveyors & Estate Agents.**

## **JOHN KYNASTON-CROSS AND THE COTTON INDUSTRY (6)**

The Industrial Revolution, concentrating cotton spinning in large mills brought about a large increase in the population of the Parish.

John Kynaston-Cross, whose life is commemorated by the window, owned cotton-spinning and weaving mills at Rose Hill and Moses Gate, later Crosses & Winkworth. He was M.P. for Bolton and Under Secretary of State for India between 1882 and 1885.

This arrangement is sponsored by **The Royal Bank of Scotland plc.**

## **WHITE MONKS OF WHALLEY ABBEY (7)**

They were the Cistercian Order of Monks - keeping sheep with the help of Lay Brothers. They were an austere and frugal order combating the luxury and wealth they felt had corrupted the monastic life. They used iron candlesticks, wooden crosses, plain linen vestments and natural woollen habits. It was the Monks from Whalley who are said to have come over to Deane to take services when necessary. The upper storey of the Church Tower was sometimes used as a dwelling place by the priest.

This arrangement is sponsored by **Fletcher New Homes.**



# GROUND FLOOR PLAN OF THE CHURCH OF ST. MARY DEANE, BOLTON

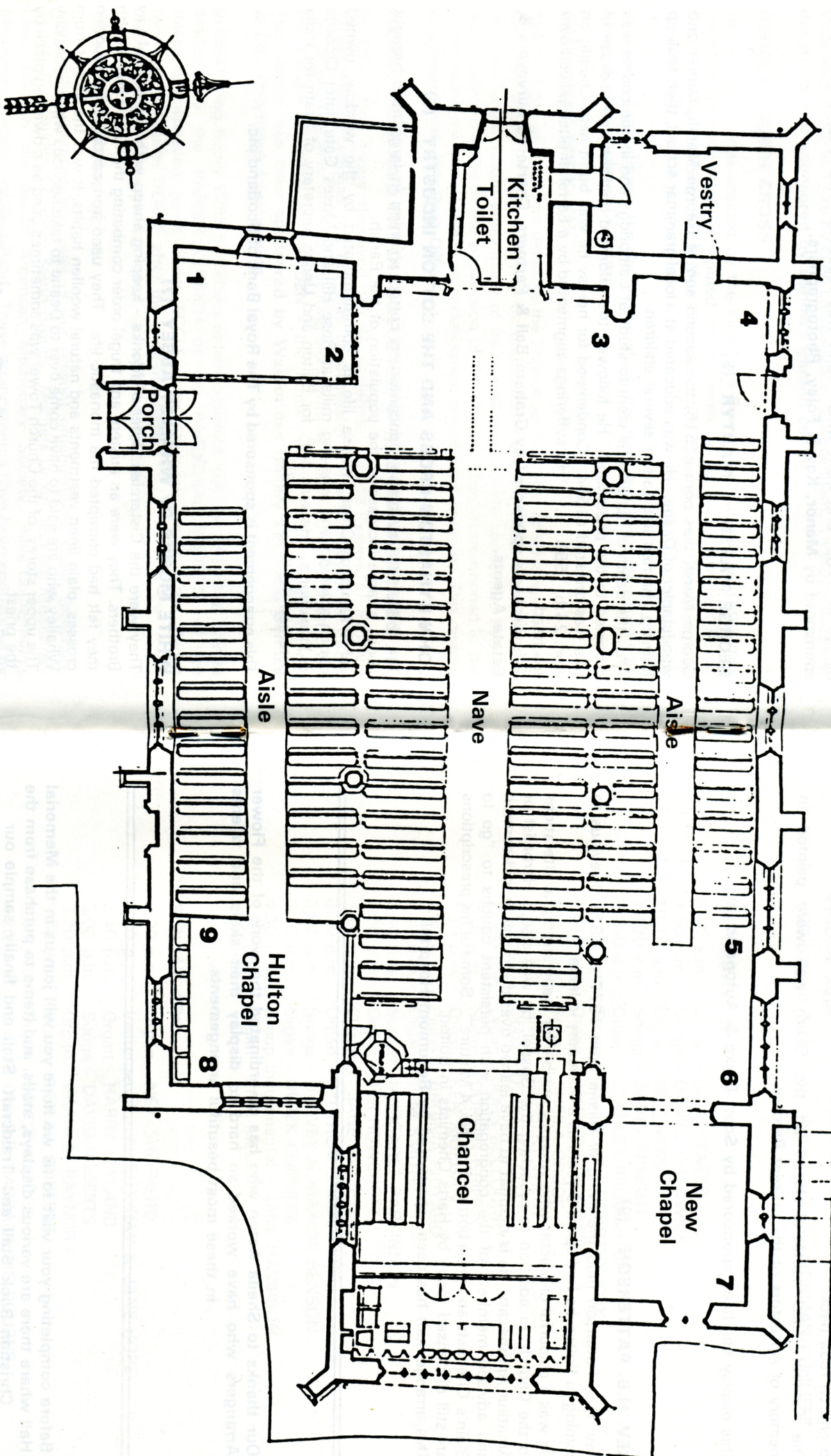



## **THE HULTON FAMILY (8)**

The Hulton's have lived at Hulton Park since Norman times. The family was the first in the area to own a 'horseless carriage' - a motor car. In Victorian times the staff at Hulton Park attended Deane Church, half of them rode there in a wagonette and walked back, whilst those who walked to church rode back.

The Funeral Hatchments displayed on the South wall were painted in memory of Ancestors of the present Baronet.

This display has been **sponsored by Scott Brake & Autoparts Ltd.**

## **REV. H.S. PATTERSON (9)**

Rev. H.S. Patterson held the living of Deane from 1877 to 1912. Previous to coming to Bolton he had spent 3 years as a Missionary in India.

He was a colourful character who was responsible for many structural alterations to the Church. In addition to preaching the Gospel, he was also a Herbalist or Amateur Apothecary. He is reputed to have leaned over the pulpit in mid-sermon and advised members of the congregation with persistent coughs to "go to Blain's Chemists and get a bottle of my No. 4 Mixture". Some of his prescriptions are still dispensed today by Harts Chemists in Bolton.

This arrangement has been **sponsored by Beaumont Hospital.**

---

---

**Our thanks to Sheila Acton who has co-ordinated the work of the Flower Arrangers who have worked so hard to display their skills and talents in these most beautiful arrangements.**

---

---

**Before completing your visit to us we hope you will join us in the Memorial Hall where there are various displays, stalls, and items to purchase from the Christian Book Stall and Traidcraft Stall and finally sample our delicious refreshments.**

# MUSIC DURING THE THANKSGIVING WEEK-END

## FRIDAY, 26th

7.00 p.m. to 7.25 p.m. Organ recital by NORMAN CUNLIFFE

## SATURDAY, 27

- 9.30 a.m. Organ - DAVID YATES
- 9.50 a.m. Songs - DANIEL CHADWICK
- 10.10 a.m. Organ - ERIC MORRIS
- 10.30 a.m. Songs - DAVID SPEIGHT
- 10.50 a.m. Organ - STANLEY BROUGHTON
- 11.10 a.m. Group Instrumental - DOROTHY COX
- 11.30 a.m. Organ - ANTHONY BOGDAN
- 11.50 a.m. Songs - SHEILA CROOK
- 12.10 p.m. Organ - HERBERT WILBY
- 12.30 p.m. Oboe - DOROTHY COX
- 12.50 p.m. Organ - JOHN BULLOUGH
- 1.10 p.m. Songs - DOREEN GRIFFIN
- 1.30 p.m. Organ - KEN MORGAN
- 1.50 p.m. Piano - VIRGINIA RIDYARD
- 2.10 p.m. Organ - TOM SMITH
- 2.30 p.m. Songs - MARGARET PARKINSON
- 2.50 p.m. Organ - JIM HOWCROFT
- 3.10 p.m. Clarinet - JANE HAMPSON
- 3.30 p.m. Organ - STEPHEN GREENHALGH
- 3.50 p.m. Songs - HARVEY & MARION BENSON
- 4.10 p.m. Organ - DEREK CUNLIFFE
- 4.30 p.m. Group Instrumental - JANE HAMPSON
- 4.50 p.m. Organ - ERIC MELLOR

## SUNDAY, 28th

- 2.00 p.m. Organ - NEIL SHEPHERD
- 2.20 p.m. Instrumental - ALISON RAY & JANE HOPE
- 2.40 p.m. Organ - HARRY LEYLAND
- 3.00 p.m. Songs - DAVID ROBERTS
- 3.20 p.m. Organ - GRAHAM RAYNOR
- 3.40 p.m. Oboe - DEANNE ROBERTS
- 4.00 p.m. Organ - JOYCE HODGES
- 4.20 p.m. Songs - CLIVE & BARBARA MELBOURNE
- 4.40 p.m. Organ - DAVID BARNES



# FROM THE CHURCHWARDENS

Since King Harold was a lad the people of Deane have kept and revered a place of worship, and because of their sacrifices it is still here for all who choose to come today. The burden does not lessen each time repairs are needed. Mainly by the efforts of the congregation the necessary expenditure of £110,000 has been met to overcome the ravages of dry rot, crumbling stone, woodworm and our climate. A child's pennies, the widow's mites, the rich man's bounty; many have given cheerfully, but it has not been easy. Say a prayer for us and help us as your circumstances permit.

Thank you.

M. CROOK

H. RIDYARD

T.J. STOKES

---

## AND FINALLY . . .

As Co-ordinator of the Celebration Weekend it is my sincere wish that you have enjoyed your visit to our historic church, that you have been made welcome, admired the beauty of the floral displays and you have been cheered by the music you have heard.

The prime object of the Celebration Weekend is not to make money for the church, but is a tangible expression of our thanks to God for all His blessings to His church over the centuries and especially to us over recent years as the extensive restoration has been carried out.

We are indebted to the members of the various Floral Art Groups who have arranged the floral displays, the visiting musicians and bellringers, the new Rosemere Operatic Society, Mrs. Marie Mitchell, all our Sponsors and Advertisers in this brochure whom we hope you will support, to you who have supported and encouraged us, and finally to our own church family who have done so much behind the scenes to ensure the success of this week-end.

STAN WILSON

---

# JAMES HART (Chemist) LTD.

FOR ALL YOUR PERFUME/COSMETIC NEEDS AT

CHRISTMAS AND THROUGHOUT THE YEAR

ORIGINAL FORMULAS DISPENSED

25 MARKET STREET, BOLTON

Telephone: (0204) 23598

---

## Graham Ball & Partners

CHARTERED SURVEYORS, AUCTIONEERS & VALUERS  
RESIDENTIAL, COMMERCIAL and INDUSTRIAL ESTATE AGENTS

Residential and Commercial Property Showroom:

47 BRADSHAWGATE, BOLTON

Tel.:

Bolton 31761 (Residential)

26333 (Commercial)

---

## SANDRA'S FLORIST 82 MORNINGTON ROAD BOLTON

*Flowers for all occasions - Weddings a Speciality*

*Fresh & Silk Flowers - Arrangements - Bouquets*

*and all Floral Tributes - Deliveries to all districts - Satisfaction Guaranteed*

---

## MICHAEL SOHOR & Co. Chartered Accountants

For advice on:

TAX PLANNING, GRANT AVAILABILITY, LOAN APPLICATIONS

Contact: Michael Sohor, A.C.A.

74 St. George's Road, Bolton BL1 2DD

Telephone: Bolton 391505

---

**Thanks to the following firms for their generous support:**

ROYAL BANK OF SCOTLAND PLC

MARKS AND SPENCERS PLC

W. & J. LEIGH & Co.

BOOTS CHEMIST

CRUSTY COB - LADYBRIDGE

WARBURTONS BAKERY

BENTLEY & Co. - CHARTERED ACCOUNTANTS

DELTA PRINT

*Thanks to all those who have so generously sponsored  
the window sills and the pew ends.*



**REFRESHMENTS**  
**ARE AVAILABLE IN THE MEMORIAL HALL**  
**(Turn left outside the Lych Gate, 50 yards up Junction Road)**

**FRIDAY**

12.00 Noon - 5.00 p.m.

**LIGHT REFRESHMENTS**

(Scones, Cakes, Biscuits, Tea - Coffee - Squash)

**SATURDAY**

10.00 a.m. - 12.00 Noon

**COFFEE AND HOME-MADE BISCUITS**

12.00 Noon - 2.00 p.m.

**PLOUGHMAN'S LUNCH**

2.00 p.m. - 5.00 p.m.

**LIGHT REFRESHMENTS**

**SUNDAY**

12.00 Noon - 2.00 p.m.

**PLOUGHMAN'S LUNCH**

2.00 p.m. - 5.00 p.m.

**LIGHT REFRESHMENTS**

**10p  
DISCOUNT ON  
REFRESHMENTS**

---

# Manor Kay & Foley

We photograph everything. Weddings,  
Commercial and Industrial. Location or Studio

**BOLTON 24028**

Town Centre Precinct, 23 Oxford Street, Bolton BL1 1RD

---

HAIR  
FASHIONS by JOHN &  
ANITA

296/298  
WIGAN ROAD  
BOLTON  
Tel.: 62781

---

## C.N. & G.P. DEAN

FRESH MILK - CREAM - EGGS

Telephones: Bolton 655681/45686

DELIVERIES TO ALL PARTS OF DEANE



---

## PHILIP GORE (Bolton) LTD.



Car and Commercial Vehicle Sales & Repairs  
Car Valeting Specialists

**12 ELLESMERE ROAD  
MORRIS GREEN  
BOLTON BL3 3JT**

For Personal Service - Telephone BOLTON 63798

---

**SHAW & SON**

**FUNERAL DIRECTORS**

**The Old Parsonage**

Richard Howard, Dip.F.D., M.B.I.F.D.

\* Chapel of Repose \* Rest Rooms  
\* Private Car Park

**20 PARK STREET, BOLTON  
Telephone: Bolton 26218**



---

KEEPING YOU INFORMED.....

# ***Bolton Evening News***

**For a Fully Comprehensive Editorial and  
Advertising Service**

**Telephone: BOLTON 22345**

---

## **LOW COST REMOVALS**

HOUSE REMOVALS

DELIVERY & TRANSPORT SERVICES

Local and Long Distance

**174 GREEN LANE, BOLTON**

**Telephone: (0204) 26019**

---



# NEWBROOK TRAVEL

Your local friendly Travel Agent  
offering a full service for all types of  
travel including Long Haul destinations  
EASY TO PARK



3 NEWBROOK ROAD, OVER HULTON

Telephone: 654711  
for Free Advice

## S. & M. ROSS (Roofing) Ltd.

TRADITIONAL ROOFING CONTRACTORS

Tel.: Bolton 396077

The Slate Yard  
Grecian Mill, Lever Street  
Bolton BL3 6PB



## BARLOW'S GARDEN CENTRE

Open 7 Days Until Late  
\*FRIENDLY EXPERT ADVICE \*DELIVERY SERVICE

WIGAN ROAD, BOLTON 655606



## McCormick & Guest

Specialists in Plumbing, Heating,  
Electrics and General Building Improvements

34 Junction Road  
Deane, Bolton

Telephone: 654503 or 491652

Pass on your  
postcode...

*write it - quote it -  
use it!*

# CACHAY

*For Fine Clothes*

302, WIGAN RD, DEANE, BOLTON.  
TELEPHONE: BOLTON 61424.

## BEAUMONT

SCHOOL OF MOTORING

Mr. T. Yates, DOT, ADI, MIAM

FOR PROFESSIONAL TUITION  
AT A COMPETITIVE PRICE  
DOOR TO DOOR SERVICE

Telephone: BOLTON 652196



## CROSSFIELD CONSTRUCTION CO. LTD.

BUILDING CONTRACTORS

Unit 3, Raphael Street  
Bolton BL1 3EQ  
Telephone: 494144